

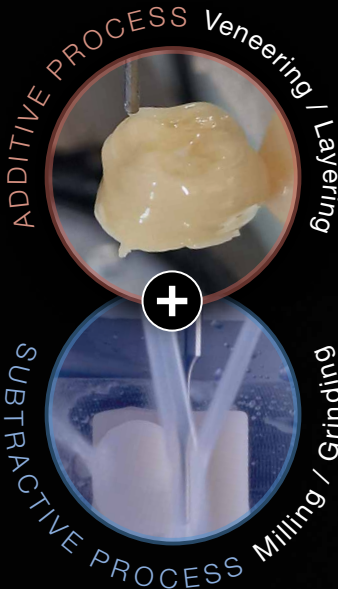

# From MYTHOS to Revolution!

Manufacturing System for Everything:  
**Additive. Subtractive. Automated.**



# Latest Technology with New Possibilities! For Better Functionality and Aesthetics.

In the dental industry, multi-material hybrid technology offers numerous advantages, especially for dentures, crowns, bridges and implants. By combining different materials, functionality as well as durability, aesthetics, comfort and biocompatibility can be improved, allowing patients to benefit from a better dental prosthesis.

- ✓ **Biocompatibility**  
Combination of ceramic, composite and zirconia for better compatibility, thanks to well-known dental veneering materials
- ✓ **Stability & durability**  
High fracture resistance thanks to hybrid materials such as metal-ceramic or zirconium oxide
- ✓ **Aesthetics**  
Natural tooth color and translucency due to multi-layered materials
- ✓ **Lightweight & comfort**  
Reduced weight improves the wearing comfort of dentures
- ✓ **Efficient fabrication**  
Faster and more precise fabrication thanks to integrated CAD/CAM system
- ✓ **Greater reproducibility**  
Fully digital manufacturing process for the production of layered restorations for consistent results
- ✓ **Marmelons realization**  
Enables the realistic realization of Marmelons
- ✓ **More time / less manual work**  
Reduction of manual work through digital planning

## Significant reduction in manual work steps thanks to fully automated digital workflow!

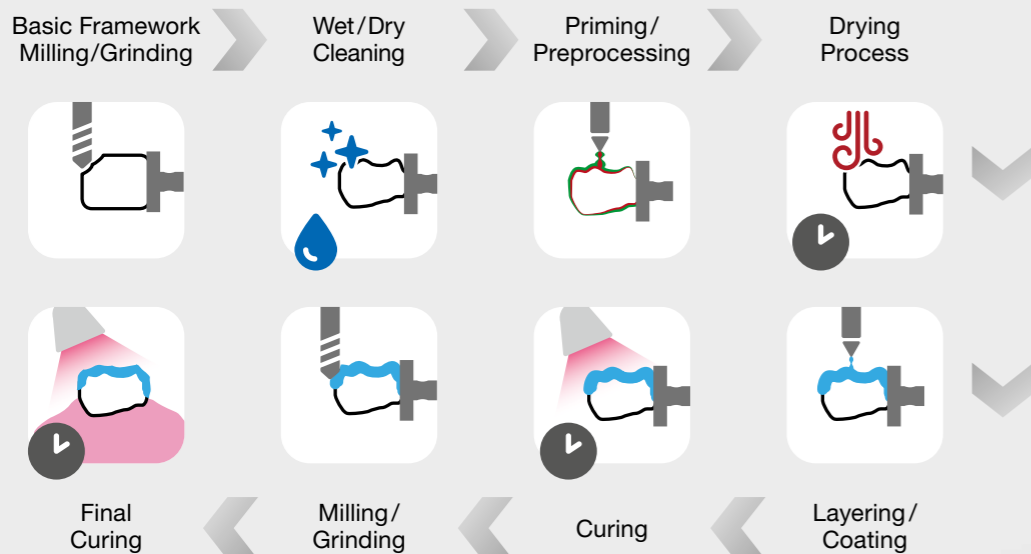

# The Next Logical Step in CAD/CAM Technology

The process combines the **flexibility of additive processes** with the **accuracy of subtractive technologies** to enable highly precise, esthetic and functional restorations.



## CORiTEC® Mythos Hybrid Process

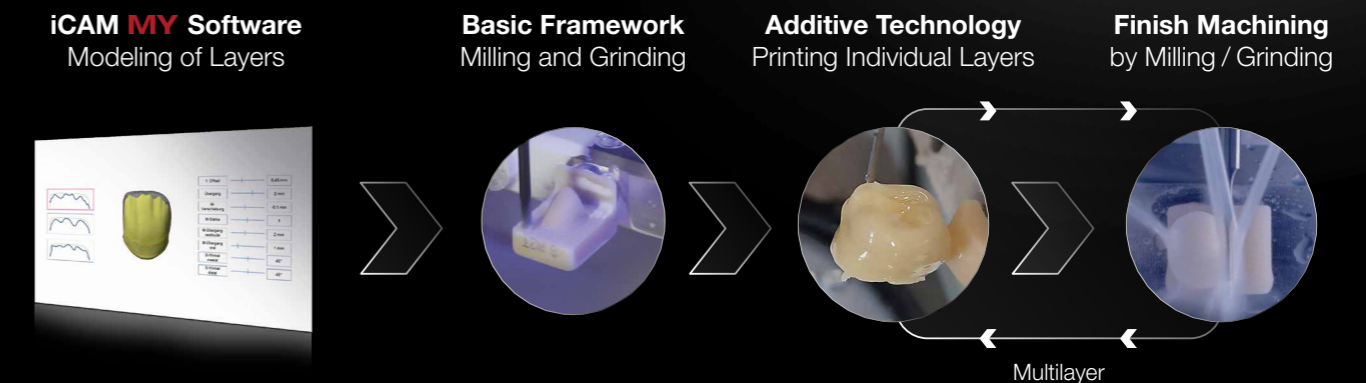

- ✓ **Higher degree of automation and material savings**  
More efficient production through full automation
- ✓ **Combination of additive and subtractive technology**  
combines freedom of creative design in coating and layering with the exceptional precision of the latest milling and grinding techniques for improved aesthetics and functionally high-precision surfaces
- ✓ **Extended material combinations [Multicolor & Multimaterial]**  
New possibilities for hybrid structures with optimized properties
- ✓ **Fully automated 5-axis hybrid process**  
Highest precision, better surface quality and more design options for multi-material and multi-color dental restorations



# Global Support

SALES AND SUPPORT PARTNERS  
IN OVER 100 COUNTRIES

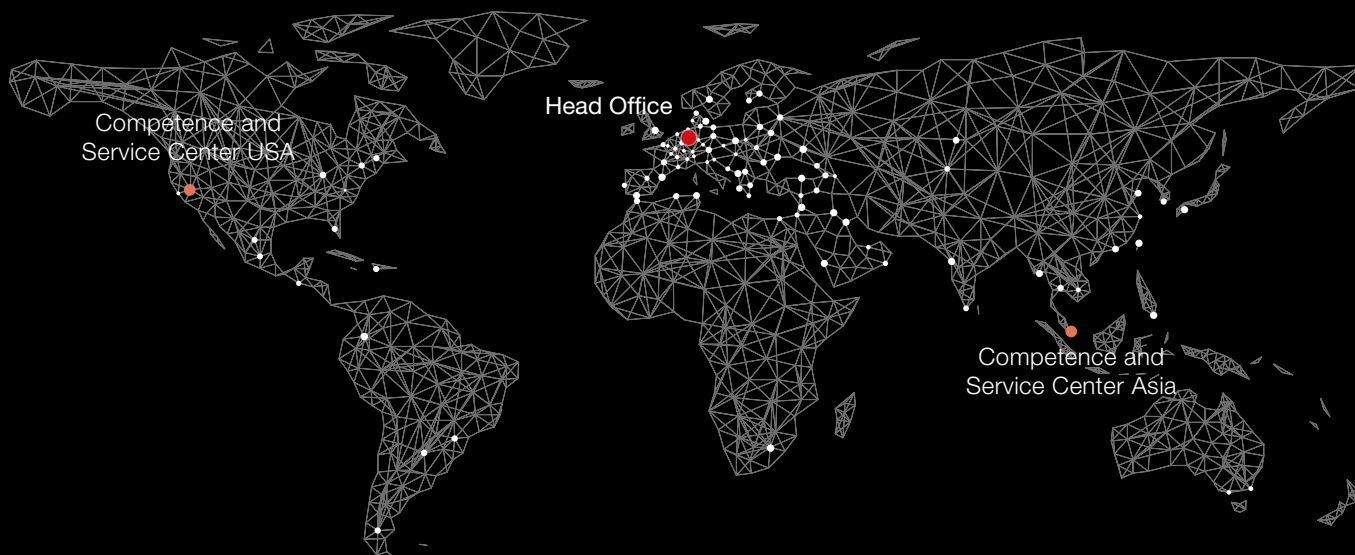

**Configure Your  
Perfect Dental  
Production  
System Now!**

Enter only your  
requirements.

**Recommendation  
and selection**  
of the suitable  
production  
system

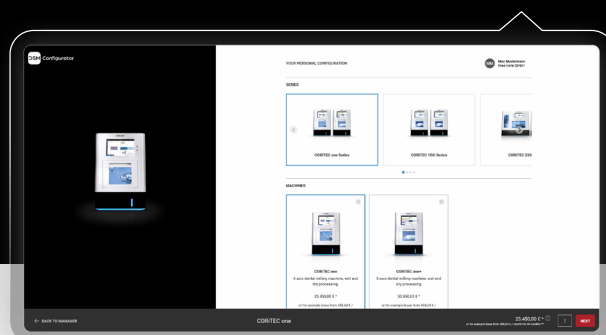
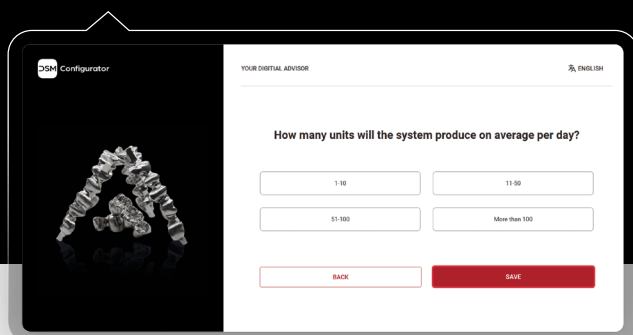

**imes-icore**<sup>®</sup>  
Dental & Medical Solutions

**imes-icore GmbH**  
Im Leibolzgraben 16  
36132 Eiterfeld

+49 (0) 66 72/898 228  
dental@imes-icore.com  
www.imes-icore.com